

# Talema Elektronik GmbH

Sembdnerstr.5, Postfach 2523, 82110, Germering.

Tel : ++49 89 841 00-0,  
Fax : ++49 89 841 00 25

Email : [info@talema.de](mailto:info@talema.de)



Customer  
Product  
Part No  
Customer Part No

**cypax**

[www.cypax.dk](http://www.cypax.dk)  
[mail@cypax.com](mailto:mail@cypax.com)

Industrivej 24  
DK-7470 Karup  
Tlf +45 9710 1188

Page : 1 of 1

Date : 27th Oct '14

## SCHEMATIC:

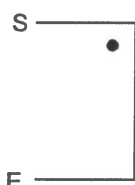

## ELECTRICAL & MECHANICAL SPECIFICATIONS:

Customer P/N	Talema P/N	Electrical Specifications @25°C			Mechanical Dimensions		
		Rated Current in Amps	Inductance in $\mu\text{H}$ (Min.) @10KHz/100mV	DCR in $\text{m}\Omega$ (Typ)	'A' (OD)	'B' (Ht)	'C' (Self lead $\phi$ )
SFT52501	21950	2	32	28	13.80	8.00	0.56
SFT830S	21951	2	28	24	13.90	8.00	0.60
SFT850D	21952	2	126	61	17.10	9.70	0.60
SFT1030	21953	3	40	18	15.90	8.50	0.80
SFT1230	21954	5	36	14	19.00	12.00	1.00
SFT1240	21955	5	68	19	21.50	13.80	1.00

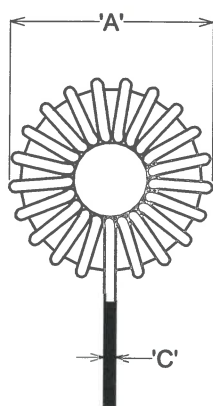

**FRONT VIEW**

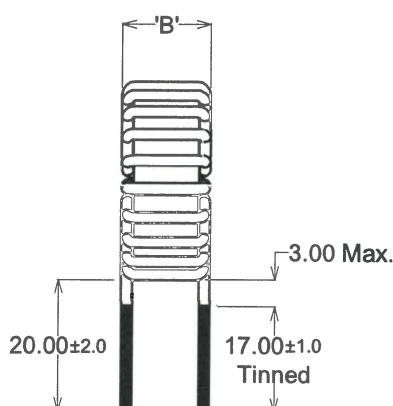

**SIDE VIEW**

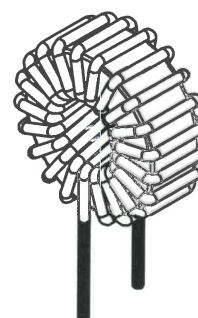

**ISOMETRIC VIEW**

Unit : mm Dimensions Tolerances :  $\pm 0.25\text{mm}$  (Unless specified)



Rev.	Description	Date	Name
3			
2			
1			
0	Initial Release	27.10.2014	M.Sheriff

**DRAFT COPY**

ISSUE : 1

REV : 0