

REV.	DESCRIPTION	DATE
△	完善圖面標註	11-30-01
△	完善圖面	12/28/01

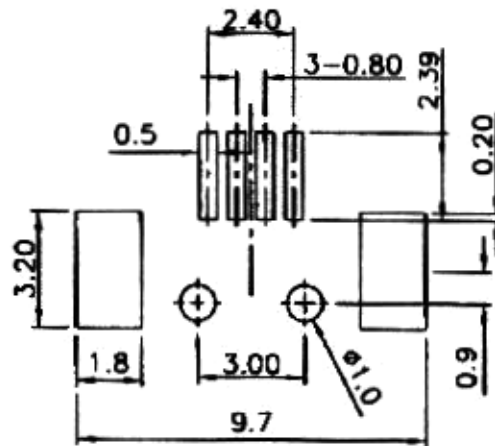

Recommard PCB Layout

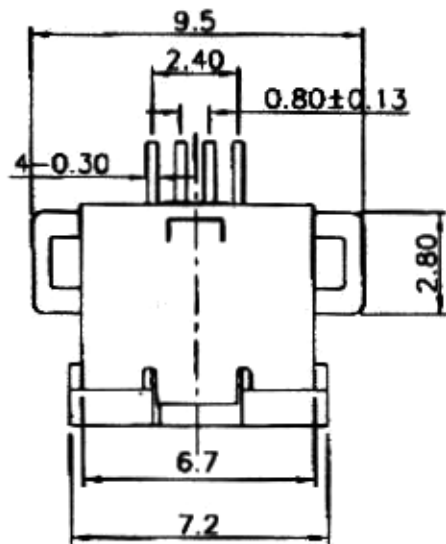
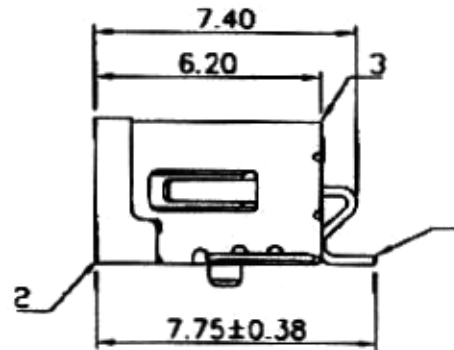
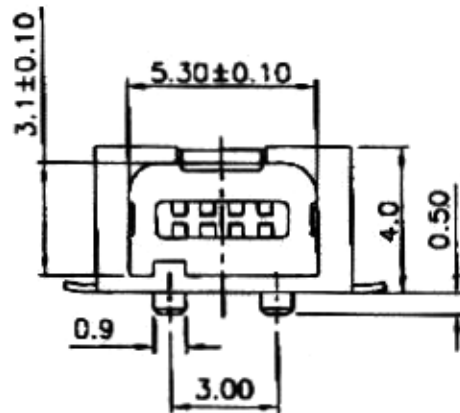

特性: Specifications:

- 電器: Electrical:
 - 接觸阻抗: Contact Resistance: 30 milliohms MAX
 - 耐電壓: Dielectric Withstanding Volloge: 250 V AC. AT Sea Level.
 - 絕緣阻抗: Insulation Resistance: 1000 MEGA ohms MIN.
- 機械: Mechanical:
 - 結合力: Mating Force: 4.0 KG MAX. 最大4kg.
 - 拔出力: Unmating Force: 0.5 KG MIN. 最少0.5kg.
- 材料: Material:
 - 塑膠: Housing: High Temperature Thermoplastics, UL 94V-0 耐高溫塑膠.
 - 端子: Contact: Copper Alloy. 銅合金.
 - 鐵殼: Shell: Copper Alloy. 銅合金.
- 電鍍: Finish:
 - 端子: Contact: Plated Gold in Mating Area; Tin/Lead On Solder Tails. 接觸點鍍金. 腳鍍錫鉛.
 - 鐵殼: Shell: Tin/Lead Plating. 鍍錫鉛. Nickel Plating. 鍍鎳.

SHALLIN ELECTRONICS CO., LTD.

GENERAL TOLERANCE

X' ± 5'	X' ±
X ± 2'	X ± 0.38
XX ± 1'	XX ± 0.25
XXX ± 0.5'	XXX ± 0.13

DRAWN 胡志偉

DATE 12/28/01

DWG. NO.

QU119-1

TITLE

MINI USB 4P
RECEPTACLE A TYPE
RIGHT ANGLE SMT

REV. 03 UNIT mm SCALE F

CHECK Z-Y-He

DATE 09-16-02

PART NO.

Y98900

APPROVE Y-C-Sung

DATE 09-16-02